

September 30 — October 1, 2013

Preventing Injury: From Research to Practice to People



A regional injury conference
sponsored by:



Midwest
Injury
Prevention
Alliance



UNIVERSITY of MICHIGAN
INJURY CENTER



Making a Difference



Transportation safety



Violence interventions



Safe prescription drug use

And much more...

We work to prevent injury by:

- Performing innovative research
- Publishing research findings and translating research into practice
- Supporting community groups
- Publishing educational materials for practitioners
- Educating students, trainees, and others
- Providing support for developing effective injury policy

Join us!

With monthly learning activities, engaged members, funding opportunities, a resource-rich website, and collaboration opportunities, the University of Michigan Injury Center provides a way to connect and grow. Become a member today!



Table of Contents

Welcome Letter	5
About the Sponsors	7
Planning Committee Members.....	7
Ann Arbor Information	8
Maps of Palmer Commons	9
About Our Featured Speakers	10
Full Program Agenda	
Day 1	11
Day 2	15
Poster Session Information	17
Notes & Doodle Pages	21
Agenda at a Glance	back cover

Fill in the bubble!

Look for the big “conversation bubble” and help us fill it in. Use bubble sticky notes to add your comments about the conference, something you learned, or a conversation you had...or plan to have. Use the agenda times shown with a  to talk with others and to write down your “bubble” notes.



INJURY RESEARCH CENTER

at the
MEDICAL
COLLEGE
OF WISCONSIN

**To help you stay
up to date on the latest
injury research in the
Great Lakes Region, visit
our web site and like us on
Facebook.**

The Injury Research Center at the Medical College (IRC-MCW) was established in 2001 as a comprehensive, federally funded Injury Research Center to address the Burden of Injury in the Great Lakes Region.



Located on the campus of the Medical College of Wisconsin, the IRC-MCW fulfills its mission of preventing and reducing injury deaths and disabilities through research, education, training and outreach.

Injuries have a devastating impact on individuals, families, the healthcare system, and society through premature death and disability, medical costs, and lost productivity. Injuries are the leading cause of death for people age 1 to 44. When combined, there are more deaths from unintentional injuries and violence than all other diseases with the exception of heart disease and cancer. Injury control research centers provide an ideal environment for concerted efforts in research, education, training and outreach to reduce the burden of injury.

<http://www.mcw.edu/injuryresearchcenter.htm>

**Follow the Injury Research Center
at the Medical College of Wisconsin on**





Let's talk...

Let's talk about injury prevention. Let's discuss what we've found in our research. Let's share ideas about programs that work. *Let's take the next two days to find ways to work together to reduce injury in our region...and beyond.*

"Translation research" can be defined in many ways. But, at its core, it's all about how all of us – researchers, practitioners, policymakers, and more – can work together to take research findings off the shelf and bring them into the real world to help real people. The 150 people here this week have ideas, answers, and solutions. This conference is designed to broaden and expand conversations that will impact our communities.

So, **welcome to "Preventing Injury: From Research to Practice to People"!** This combined Midwest Injury Prevention Alliance (MIPA)/University of Michigan Injury Center regional conference is a rare opportunity for injury prevention researchers and practitioners to come together to exchange ideas. We hope it will be an invigorating learning event for you.

The planning committee has put together an exciting agenda that covers communication techniques, updates on hot injury topics, emerging and tested methods, the national injury agenda, opportunities to network and work together, and much more.

We invite you to make the most of it. Share ideas, make connections, and join together with others to tackle the challenges we share.

Thank you for joining us. *Let's keep the conversation going!*

Sincerely,

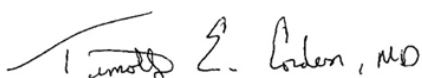

Timothy Corden, MD
Associate Professor, Pediatrics
Medical College of Wisconsin



Rebecca Cunningham, MD
Associate Professor, Emergency Medicine
University of Michigan

PS: No need to wait until the conference is over. When you hear something interesting, tweet it!

Center for Injury Research and Policy

The researchers at the Center for Injury Research and Policy are dedicated to reducing injury-related pediatric death and disability worldwide.



The Center for Injury Research and Policy (CIRP) was established in 1999. In 2001, it became the first of the 12 Centers of Emphasis within The Research Institute at Nationwide Children's Hospital. Founded and directed by Dr. Gary Smith, CIRP is also one of only 11 Injury Control Research Centers funded by the Centers for Disease Control and Prevention (CDC) and is the only one focused on injuries to children and adolescents.

CIRP works globally to reduce injury-related pediatric death and disability. With innovative research at its core, CIRP works to continually improve scientific understanding of the epidemiology, biomechanics, prevention, acute treatment and rehabilitation of injuries. CIRP serves as a pioneer by translating cutting edge injury research into education, advocacy and advances in clinical care.



About the Sponsors

“Preventing Injury: From Research to Practice to People” is sponsored by the following organizations, who provided funding for this no-cost event for attendees.



Midwest
Injury
Prevention
Alliance

The Midwest Injury Prevention Alliance (MIPA) is an organization of injury professionals from states in Federal Health and Human Services Region V (Illinois, Indiana, Minnesota, Michigan, Ohio, and Wisconsin) that works collaboratively to reduce unintentional and intentional injury-related death and disability. The goal of MIPA is to reduce unintentional and intentional injuries by fostering collaboration and communication among the MIPA network members.

www.midwestinjury.com



Among addressing other state-wide health concerns, the Minnesota Department of Health works to strengthen communities in injury and violence prevention. They collect and interpret data on injury and violence, develop and evaluate prevention programs and policies, and provide tools, technical assistance, and information to others. www.health.state.mn.us/injury



UNIVERSITY of MICHIGAN
INJURY CENTER

Working closely with faculty across many disciplines, with regional education and public health partners, and in close coordination with the CDC, we generate and share new findings about injury prevention that impact both policy and individual behavior.

www.injurycenter.umich.edu

The Planning Committee

Thanks to the members of the joint planning committee, composed of MIPA members and University of Michigan Injury Center staff and faculty, for envisioning, planning, and organizing this event. The committee welcomes your feedback, so please let them know what you like/dislike and your suggestions for future events. *(Watch your email for a post-event survey!)*

- **Bethany Buschmann**, MPH, Outreach Project Coordinator, University of Michigan Injury Center
- **Timothy Corden**, MD, Associate Professor of Pediatrics, Medical College of Wisconsin
- **Marie Crandall**, MD, MPH, FACS, Associate Professor of Surgery, Northwestern University Feinberg School of Medicine
- **Tina Creguer**, Managing Director, University of Michigan Injury Center
- **Peter Ehrlich**, MD, MSc, Associate Professor of Pediatric Surgery, University of Michigan C.S. Mott Children's Hospital
- **Mark Kinde**, MPH, Injury & Violence Prevention Program Director, Minnesota Department of Health
- **Nena Ray**, Injury Prevention Coordinator, IU Health Methodist Trauma Center
- **Linda Scarpetta**, MPH, Acting Div. Director, MI Dept. of Community Health, Chronic Disease & Injury Control Div.
- **Susan Morrel-Samuels**, MA, MPH, Managing Director, Prevention Research Ctr of MI, MI Youth Violence Prevention Ctr
- **Gary Smith**, MD, DrPH, Director, Center for Injury Research & Policy, Research Institute at Nationwide Children's Hospital

Ann Arbor Information

Excerpted from www.visitannarbor.org

Fast facts

- Population - Ann Arbor: 114,024, including the student population of the University of Michigan.
- Size - 28.2 square miles
- Average Age - 27.3 years (almost 25% of Ann Arborites are between 18 and 24)
- Education - 64.2 percent have four years of college or more

History

Ann Arbor was founded in 1824 when John Allen and Elisha Rumsey left Detroit on a one-horse sleigh and headed west to establish a new community. Originally registered as Annarbour, it is believed that the "Ann" honors their wives Ann and Mary Ann and "arbour" refers to a grove or shady opening found in the Michigan woods. Eventually the words were separated and the town became known as Ann Arbor. It remains the only city in the world with that name.

Dining options

Ann Arbor offers nearly 300 restaurants within a 20-mile radius. Options range from old-fashioned Italian bistros to trendy, contemporary American restaurants. Many offer alfresco dining in the warmer months, which, when combined with the array of jazz and dance clubs in the area, makes downtown Ann Arbor a vibrant destination for nightlife.

Check out restaurants at: <http://www.visitannarbor.org/dining>.



Transportation

To get around in downtown Ann Arbor, many visitors opt to walk. Other options include:

- **The Ride:** Operated by the Ann Arbor Transportation Authority, "The Ride" is a top-notch public transit system, offering over 1,500 stops in Washtenaw County. Fare is \$1.50 per person. Exact change is needed. Visit www.theride.org for more information.
- Taxi service: There are over 20 taxi cab service providers in Ann Arbor. See full list at: <http://www.visitannarbor.org/about-ann-arbor/transportation/taxi>

The University of Michigan



- Total Enrollment (Ann Arbor, Flint and Dearborn campuses) - 53,031, Ann Arbor Enrollment - 38,103
- Alumni Body - 439,239 living degree-holders
- Ann Arbor campus size in acres: 3,177
- Employment - In Ann Arbor, U-M employs more than 27,000 Washtenaw County residents



Photos courtesy of VisitAnnArbor.org

Maps of Palmer Commons

Entry from the parking garage bridge opens onto the 3rd floor of Palmer Commons. Just one conference session (Pediatric Injury Committee meeting) takes place on this level (in the Plaza Room, shaded blue) You may take the elevators on either the north or the south end of the building to the 4th floor.

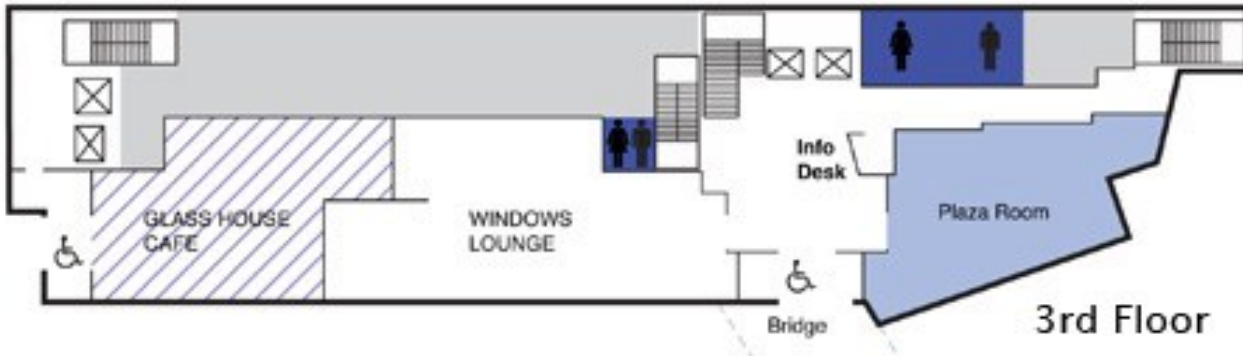

★ Most conference activities will take place on the 4th floor of Palmer Commons. Please see map below. Note that the **poster session** will take place along the windows and at the south end of the 4th floor.

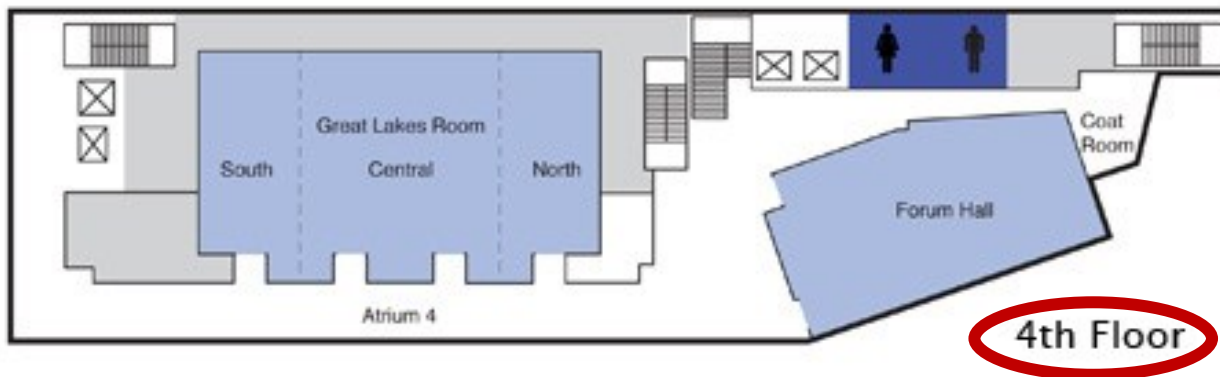

Several committee meetings will take place on the 6th floor of Palmer Commons. Note their location on the map below.

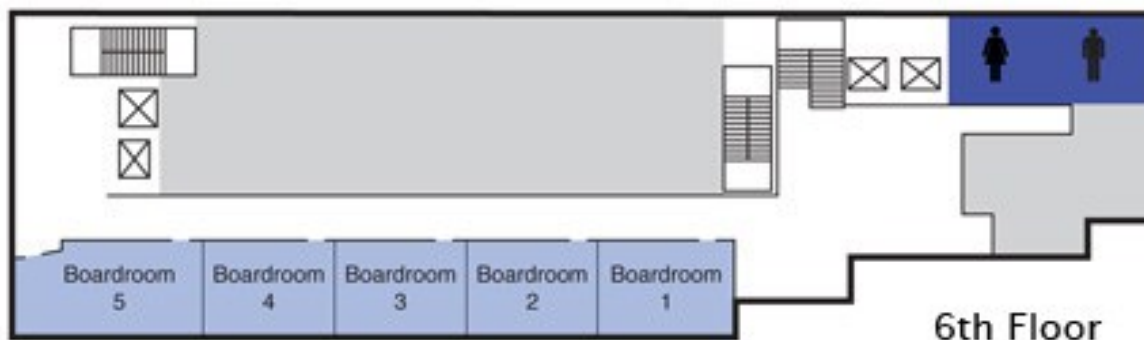

About Our Featured Speakers

We are pleased to present two national speakers at this conference who bring rare expertise and outstanding communications abilities. Be sure to catch their sessions, taking place in Forum Hall as the first event of each day, respectively. Each speaker will also participate in a breakout session, so you'll have additional opportunities to learn from them.

M
O
N
D
A
Y



Nedra Weinreich

President/Founder
Weinreich Communications

Nedra helps nonprofits and public agencies create positive change on health and social issues through social marketing and transmedia storytelling strategies at Weinreich Communications [<http://social-marketing.com>].

Nedra is a frequent speaker at conferences and trainings, using her expertise to build the knowledge and skills of professionals who want to put social marketing, social media and transmedia storytelling to work for their organizations. She teaches a graduate course on social marketing at UCLA's School of Public Health and was adjunct faculty at Georgetown University. Nedra earned her Master's degree in Health and Social Behavior from the Harvard School of Public Health.

She is the author of *Hands-On Social Marketing: A Step-by-Step Guide to Creating Change for Good* [<http://handsonsocialmarketing.com>] and writes the Spare Change blog [<http://blog.social-marketing.com>].

Nedra is also on staff at the Entertainment Industries Council.

Nedra's Twitter handle: @Nedra

T
U
E
S
D
A
Y



Grant Baldwin

Director, Division of Unintentional Injury Prevention (DUIP), National Center for Injury Prevention & Control

Dr. Baldwin joined the Centers for Disease Control Injury Center in November 2006 as acting Deputy Director. He has served as Director since 2008.

Prior to this appointment, Dr. Baldwin served as a senior advisor in the CDC Coordinating Center for Environmental Health and Injury Prevention and the National Center for Environmental Health Agency for Toxic Substances and Disease Registry. He began his career at CDC in September 1996.

Dr. Baldwin received his PhD in Health Behavior and Health Education at the University of Michigan School of Public Health in 2003. He also received a MPH in Behavioral Sciences and Health Education from the Rollins School of Public Health at Emory University in 1996.

Dr. Baldwin is an adjunct Assistant Professor in the Department of Behavioral Sciences and Health Education for the Rollins School of Public Health at Emory University. He teaches two courses in the distance-based MPH program.



Preventing Injury: From Research to Practice to People

The Program

Monday, September 30th

8:30 – 9:00 **Registration & Continental Breakfast** 
4th-Floor Atrium

9:00 – 9:15 **Welcome & Opening Remarks**
Forum Hall Auditorium – 4th Floor

- **James Woolliscroft, MD**, Dean, University of Michigan Medical School

9:15 – 10:15 **KEYNOTE ADDRESS**
Forum Hall Auditorium – 4th Floor

- **Nedra Weinreich, MS**, President/Founder, Weinreich Communications



Effective Social Media is No Accident: A Roadmap for Injury Prevention Success

Whether you're a social media pro or just starting out, being strategic about your social media activities is critical to your effectiveness. This presentation will lead you through the steps for developing a social media strategy and offer tips for how to make the most of your interactions online.

10:15 – 10:30 **Break** 
4th-Floor Atrium

10:30 – 12:00 **EFFECTIVE PROGRAMMING BREAKOUT SESSIONS (concurrent)**

A: Motor Vehicle Crashes: New Challenges and Opportunities for Prevention

Forum Hall Auditorium – 4th Floor

Despite dramatic improvements in safety and reductions in fatality rates, motor vehicle crash (MVC) remains a leading cause of injury death. What's next in transportation safety? How can we continue to make automobile travel safer? Attend this session to learn about the latest advancements in reducing MVC injury and how research findings on child occupant protection, young drivers, and vehicle safety can be put into practice.

- **Moderator:** Jean Shope, PhD, MSPH, Research Professor, University of Michigan Transportation Research Institute, University of Michigan School of Public Health
- **Speakers:**
 - Michelle Macy, MD, MS, Pediatric Emergency Physician, University of Michigan
 - *The Latest in Child Passenger Safety – How Does Child Size Fit In?*
 - Jennifer Zakrajsek, MS, MPH, Senior Research Associate, University of Michigan Transportation Research Institute
 - *Translation Research to Reach Parents With an Effective Intervention to Reduce Teen Driving Risk*
 - Jonathan Rupp, PhD, MS, Research Associate Professor, University of Michigan Transportation Research Institute
 - *How Occupant Protection Systems Prevent Injuries in Motor-Vehicle Crashes*



Session to be videotaped; will be available on UM Injury Center website.

B: Prescription Drug Overdose: Tackling an Emerging Epidemic

Great Lakes Room, North

Prescription drug overdose deaths in the US have tripled since 1990, and this issue has emerged as an urgent public health crisis. Attend this session to learn what is driving the overdose increase, what programs have been most effective in addressing it, and how you can educate your community about overdose prevention.

- **Moderator:** Joan Duwve, MD, MPH, Chief Medical Officer, Indiana State Department of Health
- **Speakers:**
 - Grant Baldwin, PhD, MPH, Director, National Center for Injury Prevention and Control, Centers for Disease Control and Prevention, Division of Unintentional Injury
 - *Curbing the National Epidemic. What Is the Problem and How Can We Fix It?*
 - Marty Allain, NARxCHECK Senior Manager, National Association of Boards of Pharmacy
 - *PDMPs – Building an Effective Monitoring System From Ground Up, Data Sharing Across State Lines and With EMR's, Highlighting INSPECT in Indiana*
 - Christy Beeghly, MPH, Violence and Injury Prevention Program Administrator, Ohio Department of Health
 - *Establishing Prescriber Guidelines for Opioid Prescribing in Acute and Chronic Pain in Ohio*
 - Cameron McNamee, Injury Prevention Policy Specialist, Ohio Department of Health
 - *Naloxone Programs to Prevent Fatal Overdoses, Highlighting Project DAWN in Ohio*

C: Violence: How Data Informs Prevention

Great Lakes Room, Central

Preventing violence begins with a solid understanding of where and how violence is occurring and by introducing effective, proven programs that address all aspects of this complex problem. In this session, you'll hear how states are collaborating to share and analyze data and how prevention programs are using data to address violence before it occurs.

- **Moderator:** Linda Scarpetta, MPH, Acting Director, Division of Chronic Disease and Injury Control, Michigan Department of Community Health
- **Speakers:**
 - Patricia Smith, MS, Violence Prevention Program Coordinator, Injury and Violence Prevention Section, Michigan Department of Community Health
 - *NVDRS System in Michigan*
 - Jolene DeFiore-Hyrmer, Program Manager, Ohio Department of Health, Ohio Violent Death Reporting System
 - *NVDRS System in Ohio*
 - Steven Stack, PhD, Professor, Wayne State University
 - *New Risk Factors for Suicide: Mining the NVDRS: Analysis of 30,000 Cases*
 - Jessica Roche, MPH, Project Coordinator, University of Michigan Injury Center, Michigan Youth Violence Prevention Center
 - *Project Sync in Flint, Michigan*

D: Concussions: What We Know About What Works

Great Lakes Room, South

Concussion—particularly sports concussion—is a hot media topic and a health risk that affects many people, especially youth. As we learn more about the short and long-term effects of these too-long-ignored brain injuries, their importance as a public health issue only grows. Hear about the latest scientific discoveries, policy updates, and new tools to share with your community to prevent concussion.

- **Moderator:** Peter Ehrlich, MD, MSc, Associate Professor of Pediatric Surgery, University of Michigan C.S. Mott Children's Hospital

- **Speakers:**
 - Hugh Garton, MD, MHSc, Associate Professor, University of Michigan Neurological Surgery
 - *Science & Concussion*
 - Jeffrey Kutcher, MD, Director of Michigan Neurosport, University of Michigan Health System
 - *Concussion & Sports*
 - Amy Teddy, Injury Prevention Program Manager, University of Michigan C.S. Mott Children's Hospital
 - *Return-to-Play App for Parents*

12:00 – 1:15 **Networking Lunch**
 4th-Floor Atrium 
 All breakout rooms & Forum Hall available for eating lunch

1:15 – 2:30 **EFFECTIVE METHODS BREAKOUT SESSIONS (concurrent)**

E: Evaluating Injury Prevention Programs

Forum Hall Auditorium – 4th Floor

How do we know that our injury prevention education and intervention programs are working? Learn practical approaches to evaluation that will help you assess and improve your prevention efforts.

- **Moderator:** Maureen Walton, PhD, MPH, Associate Professor, University of Michigan, Department of Psychiatry
- **Speakers:**
 - Thomas M. Reischl, PhD, Associate Research Scientist & Evaluation Director, Prevention Research Center of Michigan, University of Michigan School of Public Health
 - *Conducting Useful Evaluations of Injury Prevention Programs*
 - Maureen Walton, PhD, MPH, Associate Professor, University of Michigan, Department of Psychiatry
 - *SaferTeens Research Study in Flint, Michigan*

F: Shaping Injury Prevention Policy

Great Lakes Room, Central

How can we influence public policy to reduce injury in a tangible way? Hear real-world examples of successful policy change based upon evidence from the field and learn tactics for communicating and educating policy-makers.

- **Moderator:** Susan Morrel-Samuels, MA, MPH, Managing Director, Prevention Research Center of Michigan, Michigan Youth Violence Prevention Center
- **Speakers:**
 - Jenifer Martin, JD, Director of Government Relations, University of Michigan School of Public Health, University of Michigan Institute for Healthcare Policy and Innovation
 - Timothy Corden, MD, Associate Professor of Pediatrics, Medical College of Wisconsin
 - Nancy Cowles, Executive Director, Kids in Danger

G: Communicating with the Media

Great Lakes Room, North

Why you should share your research with the media, what you need to do to attract their interest, and how to make the most of it. Learn techniques to improve your media communications and to make your research findings more actionable.

- **Moderator:** Gary Smith, MD, DrPH, Director, Center for Injury Research and Policy, The Research Institute at Nationwide Children's Hospital
- **Speakers:**
 - Tracy Mehan, MA, Director of Translational Research, Center for Injury Research and Policy, The Research Institute at Nationwide Children's Hospital

- *Talking to the New York Times: Why You Should Share Your Public Health Messages With the Media and How To Get Them Interested*
- Nedra Weinreich, MS, President/Founder, Weinreich Communications
 - *Reaching Reporters Through the Cloud: Harnessing Social Media To Get Your Stories Covered*

H: Making the Most of Injury Data

Great Lakes Room, South

How can states and localities obtain, analyze, and link injury data to practice improvements? State and local health department experts will discuss how they used their data systems to prevent injury.

- **Moderator:** Mark Kinde, MPH, Injury and Violence Prevention Program Director, Minnesota Department of Health
- **Speakers:**
 - Jon Roesler, MS, Injury Epidemiologist Supervisor, Minnesota Department of Health
 - Adreanne Waller, MPH, Epidemiologist, Senior Health Analyst, Washtenaw County Public Health Department

2:30 – 2:45

Break

4th-Floor Atrium



2:45 – 3:45

PLENARY PANEL: Partners in Prevention: How Researchers and Practitioners Are Working Together to Create Safer Communities

Forum Hall Auditorium – 4th Floor

See how research and practice are coming together in very real ways to help communities prevent injury. Featuring speakers from injury research centers and community health organizations, you'll see examples of how collaboration and communication among researchers and practitioners enable creative approaches to injury concerns.

- **Moderator:** Marie Crandall, MD, MPH, FACS, Associate Professor of Surgery, Northwestern University Feinberg School of Medicine
- **Speakers:**
 - Rebecca Levin, MPH, Strategic Director, Injury Prevention and Research Center, Ann & Robert H. Lurie Children's Hospital of Chicago
 - Karen Sheehan, MD, MPH, Medical Director, Injury Prevention and Research Center, Ann & Robert H. Lurie Children's Hospital of Chicago
 - Marc Zimmerman, PhD, Associate Director, University of Michigan Injury Center
 - Mark Valacak, MPH, Health Officer/Director, Genesee County Health Department

3:45 – 5:30

Poster Session & Lights Refreshments

4th-Floor Atrium



*See page 16 of this program for a complete listing of posters and presenters.

Tuesday, October 1st

8:30 – 9:00 **Registration & Continental Breakfast** 
4th-Floor Atrium
NOTE: Coat room available for storing luggage

9:00 – 9:05 **Opening Remarks**
Forum Hall Auditorium – 4th Floor

- **Martin Philbert, PhD**, Dean, University of Michigan School of Public Health

9:05 – 10:00 **PLENARY SESSION**
Forum Hall Auditorium – 4th Floor

- **Grant Baldwin, PhD, MPH**, Director, National Center for Injury Prevention and Control, Centers for Disease Control and Prevention, Division of Unintentional Injury



By Every Measure – Opportunities in Injury Prevention Across the Lifespan

This plenary session will showcase the most pressing issues in unintentional injury prevention across the lifespan. Special emphasis will be given to child injury prevention and opportunities laid out in the National Action Plan. Dr. Baldwin will also discuss the growing problem of older adult fall prevention as the American population ages – including outlining potential linkages between public health and clinical practice.

10:00 – 10:15 **Break** 
4th-Floor Atrium

10:15 – 11:30 **BREAKOUT SESSIONS (concurrent)**

I: Working with Crash Datasets to Understand Traffic Safety

Forum Hall Auditorium – 4th Floor

- **Coordinator:** Ray Bingham, PhD, Research Professor, University of Michigan Transportation Research Institute
- **Speaker:**
 - Jonathan Rupp, PhD, MS, Research Associate Professor, University of Michigan Transportation Research Institute

J: MIPA Child Injury Prevention Committee

Plaza Room – 3rd Floor

- **Leaders:**
 - Rebecca Levin, MPH, Strategic Director, Injury Prevention and Research Center, Ann & Robert H. Lurie Children's Hospital of Chicago
 - Amy Teddy, Injury Prevention Program Manager, University of Michigan C.S. Mott Children's Hospital

K: MIPA Older Adult Falls Committee

Boardroom 1 – 6th Floor

- **Leader:** Christy Beeghly, MPH, Violence and Injury Prevention Program Administrator, Ohio Department of Health



Session to be videotaped; will be available on UM Injury Center website.

L: MIPA Prescription Drug Abuse Committee

Boardroom 2 – 6th Floor

- **Leader:** Joan Duwve, MD, MPH, Chief Medical Officer, Indiana State Department of Health

M: MIPA Membership Committee

Boardroom 3 – 6th Floor

- **Leader:** Todd Emanuel, RN, BSN, Injury Prevention Coordinator, Mayo Clinic

11:30 – 11:45 **Break**
4th-Floor Atrium



11:45 – 12:15 **Closing Remarks**
Forum Hall Auditorium – 4th Floor

- Timothy Corden, MD, Associate Professor of Pediatrics, Medical College of Wisconsin
- Rebecca Cunningham, MD, Director, University of Michigan Injury Center

12:15 – 1:15 **Box Lunch**
4th-Floor Atrium
All boardrooms & Forum Hall available for eating lunch



Membership X2!

Stay connected after the conference! Stop by the registration desk during the conference and sign up for membership with:

University of Michigan Injury Center

AND

Midwest Injury Prevention Alliance

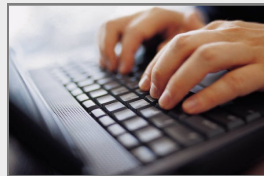

Or visit these websites: <http://injurycenter.umich.edu> & www.midwestinjury.com. A few minutes invested now will keep you connected to fellow injury professionals, events, resources, funding opportunities, and more all year 'round.

Poster Presentations

Position	Presenter	Affiliation	Title
1	Hannah Jary	Michigan Department of Community Health	Violent and Depressive Behaviors and Related Alcohol Consumption reported by Michigan High School Youth, 2011
2	Jennifer Walthall	Indiana University School of Medicine Clinical Emergency Medicine & Pediatrics	And the Seventh Day They Rested: Spatiotemporal Patterns of Urban Pediatric Violent Injury
3	Jessica Roche	University of Michigan Injury Center & Youth Violence Prevention Center	Measuring Digital Dating Violence and Associated Risk Behaviors in a Low Socio-Economic Urban Adolescent Population
4	Ileisha Sanders & Sara Konrath	University of Michigan School of Public Health & Institute for Social Research	Regional and cross-temporal variations in frequency and severity of US school shootings
5	Steven Meanley	University of Michigan School of Public Health, Center for Sexuality & Health Disparities	Interpersonal Violence Against Sexual Minority Youth in the Detroit Metropolitan Area
6	Jennifer Pierce	University of Michigan School of Public Health Department of Health Behavior & Health Education	The Moderating Role of Feared Possible Selves on the Relationship Between Peer Influence and Delinquency
7	Sheila Regan	Northwestern University Feinberg School of Medicine	Making a Positive Change in Communities Under Siege: Northwestern Memorial Hospital & LIVID Chicago Coalition.
8	Douglas Roehler	University of Michigan School of Public Health	Translating the Global Helmet Vaccine Initiative to Uganda: An evaluation of motorcycle education and helmet distribution workshops
9	Danielle Jacobs	Michigan Department of Community Health	A Practice-Based Internship

Poster Presentations

Position	Presenter	Affiliation	Title
10	Michelle Williams	University of Michigan C.S. Mott Children's Hospital Pediatric Trauma Program	Digital Devices: Placing teen pedestrians at risk?
11	Stephanie Saylor	University of Michigan School of Public Health Department of Environmental Health Sciences	Pilot Evaluation of Risk Factors for Adverse Interactions Between Drivers and Bicyclists
12	Michelle Macy	University of Michigan Department of Emergency Medicine & Pediatrics	Distracted Drivers; At Risk Child Passengers
13	Anne Goodman	Ohio Health, Grant Medical Center Trauma Services	Assessing the Effectiveness of an Advanced Driver Training Course on Driving Knowledge and Skills, Skill Retention and Driving Record
14	Peter Song	University of Michigan School of Public Health, Department of Biostatistics	Analysis of spatial variations in the effectiveness of graduated driver's licensing (GDL) program in the state of Michigan
15	Debbie Falkenberg	Covenant HealthCare Trauma Program	Avoid Trauma: Don't Drive Distracted
16	Patrick M. Carter	University of Michigan School of Medicine Department of Emergency Medicine	Social Normative Influences and Risk Perception: Predictors of Distracted Driving Behavior Among Novice Adolescent Drivers
17	Farideh Almani	University of Michigan Transpiration Research Institute	Experimental Effects of Injunctive Norms on Simulated Risky Driving Among Teenage Males
18	Jennifer Zakrajsek	University of Michigan Transpiration Research Institute	Comparing Promotional Strategies to Broadly Disseminate an Effective Teen Driving Intervention to Parents Via the Web

Poster Presentations

Position	Presenter	Affiliation	Title
19	Jennifer Zakrajsek	University of Michigan Transpiration Research Institute	Developing and evaluating an evidence-based parent guide for coaching teen drivers.
20	Erin Bonar	University of Michigan Department of Psychiatry	Driving After Drinking & Riding with a Drinking Driver: Prevalence and Correlates Among Adolescents and Emerging Adults in the Emergency Room
21	Anna Eisenberg	University of Michigan Department of Psychiatry	Development of a Brief Prescription Opioid Overdoses Prevention Intervention
22	Lynn Massey	University of Michigan Department of Psychiatry	Computer-Enhanced Interventions for Drug Use and HIV Risk in the Emergency Room
23	Jennie Jester	University of Michigan Department of Psychiatry	Decreasing child abuse potential in a sample of substance-abusing women: an attachment-based intervention
24	Quyen Epstein-Ngo	University of Michigan Substance Abuse Research Center	Increases in Mindfulness Skills to Reduce Injury, Alcohol Use and Symptoms of Depression
25	Blake Wagner	Healthy Minds Network	An innovative online video-based intervention for promoting access to mental health care and reducing suicide risk factors in the college student population
26	Steven Stack	Wayne State University	Bridge Suicide Prevention: Assessing Long Term Impacts of Emergency Phones, Skyway Bridge, 1954-2012
27	Elham Mahmoudi	University of Michigan Department of Physical Medicine & Rehabilitation	Racial/Ethnic Disparity in Rehospitalization Among Individuals with Spinal Cord Injury: A Longitudinal Analysis
28	Martin Forchheimer	University of Michigan Department of Physical Medicine & Rehabilitation	Explanation of the incidence of emergency room visits and hospitalization among people with chronic spinal cord injuries

Poster Presentations

Position	Presenter	Affiliation	Title
29	Alisha Kamboj	The Ohio State University & Nationwide Children's Hospital	Epidemiology of At-Home Traumatic Brain Injuries to Children under the Age of Five in the United States, 1990-2012
30	Yi Ou	University of Michigan School of Public Health & C.S. Mott Children's Hospital - Pediatric Trauma	Understanding Childhood Non Accidental Trauma: Guidelines are needed for Trauma Surgeons and Centers
31	Kimberly Price	Cincinnati Children's Hospital Medical Center	Community Partnerships and Taking Action to Prevent Childhood Injuries in the Home
32	Amrit Kamboj	Ohio State University & Nationwide Children's Hospital	Non-fatal Injuries to Children in the United States, 1990-2012
33	Karla Klas	University of Michigan Trauma Burn Center	School-Based Prevention Program is Associated with Increased Short- and Long-Term Knowledge Retention of Fire and Life Safety
34	Rachel Welch	Ohio State University & Nationwide Children's Hospital	Nursemaid Elbow Injuries to Children in the United State 1990-2011
35	Nancy Cowles	Kids in Danger (KID)	KID Uses Research on Choking Incidents to Improve Toy Safety Standards for Small Parts
36	Max Smith	Nationwide Children's Hospital Center for Injury Research and Policy	Out-of-Hospital Medication Errors Among Children Younger than Six Years of Age in the United States, 2002-2012
37	Judith Hirschfeld	Mount Carmel Health System Trauma Services	Active and Independent; traditional exercise program and/or Tai Chi for seniors

Doodles

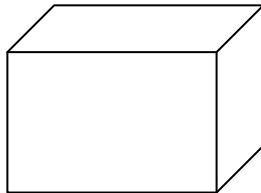
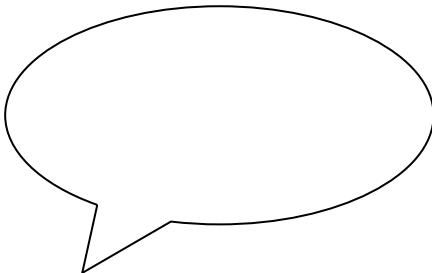
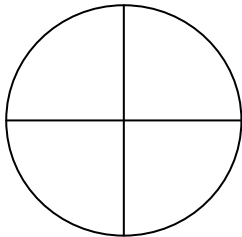
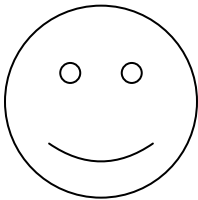

Midwest Injury Prevention Alliance

SUCCESS
share program experiences to build and refine programs throughout the region

FUNDING
learn novel funding approaches and what others are doing with limited funding

NETWORKING
connect with injury and violence professionals across the states in region 5

Indiana
Illinois
Michigan
Minnesota
Ohio
Wisconsin



GUIDE CHANGE
through access to leadership growth, influence within MIPA committees and governance, and regional professional networks

STRENGTH IN NUMBERS
opportunities to combine local and state data with regional experience for use in research, program development, and advocacy



Join a network of injury and violence professionals working together to make a lasting impact on their communities, states, and nationwide.



POLICY INITIATIVES
work with other members to develop advocacy strategies and materials, and to develop policy initiatives for local, state, regional and national agendas

To join, visit us at www.MidwestInjury.com/members to complete a membership application.





Preventing Injury: From Research to Practice to People

AGENDA

Monday, September 30, 2013

8:30 a m - 9:00 a m	Registration and Continental Breakfast (4 th -floor atrium)			
9:00 a m - 10:15 a m	WELCOME – James Woolliscroft, MD KEYNOTE ADDRESS – Nedra Weinreich, MS “Effective Social Media Is No Accident: A Roadmap for Injury Prevention Success” (Forum Hall)			
10:15 a m - 10:30 a m	Break			
10:30 a m - 12:00 p m	EFFECTIVE PROGRAMMING BREAKOUT SESSIONS			
	A Motor Vehicle Crashes (Forum Hall)	B Prescription Drug Overdose (Great Lakes, North)	C Violence (Great Lakes, Central)	D Concussions (Great Lakes, South)
12:00 p m - 1:15 p m	Networking Lunch (4 th -floor atrium)			
1:15 p m - 2:30 p m	EFFECTIVE METHODS BREAKOUT SESSIONS			
	E Evaluating Injury Prevention Programs (Forum Hall)	F Shaping Injury Prevention Policy (Great Lakes, Central)	G Communicating with the Media (Great Lakes, North)	H Making the Most of Injury Data (Great Lakes, South)
2:30 p m - 2:45 p m	Break			
2:45 p m - 3:45 p m	PLENARY PANEL: “Partners in Prevention: How Researchers and Practitioners Are Working Together to Create Safer Communities” (Forum Hall)			
3:45 p m - 5:30 p m	Poster Session (4 th -floor atrium) <i>Light refreshments served</i>			

Tuesday, October 01, 2013

8:30 a m - 9:00 a m	Registration and Continental Breakfast (4 th -floor atrium)				
9:00 a m - 10:00 a m	INTRODUCTION – Martin Philbert, PhD PLENARY ADDRESS – Grant Baldwin, PhD, MPH “By Every Measure – Opportunities in Injury Prevention Across the Lifespan” (Forum Hall)				
10:00 a m - 10:15 a m	Break				
10:15 a m - 11:30 a m	BREAKOUT SESSIONS				
	I Working with Crash Datasets (Forum Hall)	J MIPA Child Injury Prevention (Plaza Rm, 3 rd floor)	K MIPA Older Adult Falls (Boardroom 1, 6 th floor)	L MIPA Prescr. Drug Abuse (Boardroom 2, 6 th floor)	M MIPA Membership (Boardroom 3, 6 th floor)
11:30 a m - 11:45 a m	Break				
11:45 a m - 12:15 p m	CLOSING (Forum Hall)				
12:15 p m - 1:15 p m	Box Lunch (4 th -floor atrium)				